

18kg

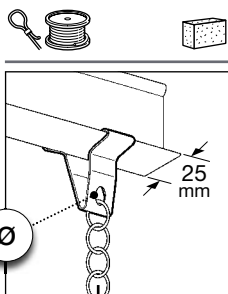

781011 18040	BA-4-16-H	WHITE	100
781011 03891	BA-4-16-H-MZ	M-ZINC	25



18kg



Ø mm



781011 04449	BA-4-16-H-1	7	100
---------------------	-------------	---	-----

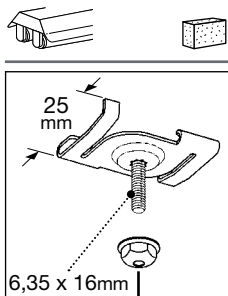

11kg



781011 03888	BA-2-16	25
---------------------	---------	----

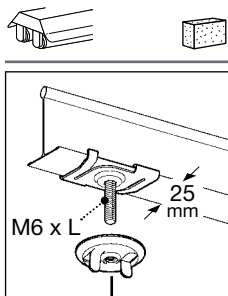

22kg



L mm



781011 04518	BMA-4-16-6	11	25
781011 03883	BMA-4-16	16	25
781011 04567	BMA-4-16-16	25	25
781011 03884	BMA-4-16-24	38	25
781011 03886	BMA-4-16-32	51	25
781011 03887	BMA-4-16-48	76	25

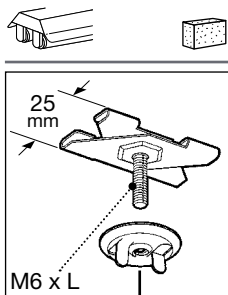

22kg



L mm



781011 04392	BMAX-4-16	16	25
781011 04393	BMAX-4-16-24	38	25
781011 04451	BMAX-4-16-32	51	25
781011 04452	BMAX-4-16-48	76	25

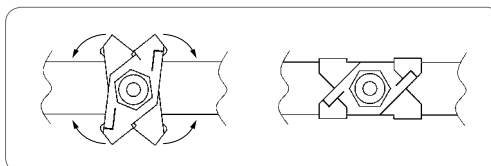



781011 03882

BA-4-WN

25

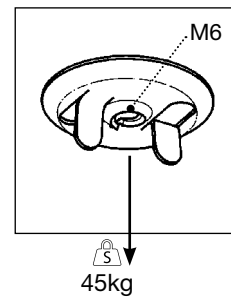

781011 03892

BMA-4-9

25

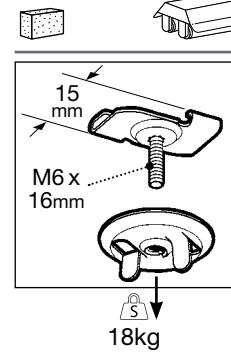

781011 03787

BA5-4T

25

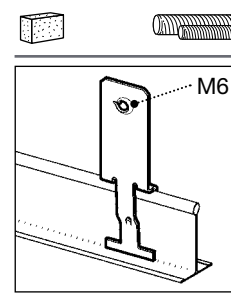

781011 03794

BA6-4T

25

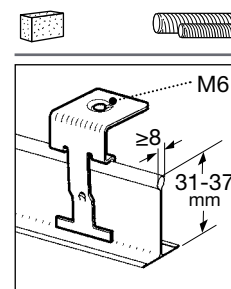

L
mm



781011 03784

BMA1

16

25

781011 03785

BMA1-24

38

25

781011 03786

BMA1-32

51

25

